

SOLD



e|va

320 - 25TH AVENUE SW
CALGARY, AB

Newer Concrete Construction,
Boutique Apartment Building
Situated in the Heart of Calgary's
Lively Inner-City Community
of Mission

VENDOR
Wexford Developments LP

PURCHASER
Manulife



Property Details



ADDRESS

320 25TH AVENUE SW

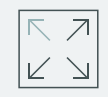

LAND AREA

13,025 SF

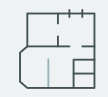

OF UNITS

61



CLOSING DATE

DECEMBER 2024

Highlights

- ▶ 61 contemporary, boutique rental units with balconies, underground parking and a rooftop patio in Calgary's highly sought-after community of Mission
- ▶ Situated in the heart of Mission with immediate access to Calgary's vibrant cafes, dining and entertainment establishments located along Mission's trendy 4th Street
- ▶ Only a 20 minute walk and 10 minute bike ride to the downtown core and a 10 minute walk or 4 minute bike ride to Calgary's 17th Avenue Entertainment District

For more information, please contact:

Duncan MacLean
Executive Vice President
403 750 0800
duncan.maclean@cbre.com

Richie Bhamra
Executive Vice President
403 303 4569
richie.bhamra@cbre.com

Geoff Mar
Senior Vice President
403 750 0512
geoff.mar@cbre.com

Tyler Allen
Senior Vice President
403 750 0521
tyler.allen@cbre.com

Drew Redekopp
Associate Vice President
403 750 0504
drew.redekopp@cbre.com

Austin Croft
Senior Financial Analyst
403 716 2344
austin.croft@cbre.com

Thomas Lee
Senior Financial Analyst
403 716 2346
thomaslee@cbre.com

Patrick Dea
Financial Analyst
403 750 0801
patrick.dea@cbre.com

Meagan Pitre
Marketing Specialist
403 294 5703
meagan.pitre@cbre.com

NATIONAL INVESTMENT TEAM | CALGARY

This disclaimer shall apply to CBRE Limited, real estate brokerage, and to all other divisions of the corporation, to include all employees and independent contractors ("CBRE"). The information set out herein, including, without limitation, any projections, images, opinions, assumptions and estimates obtained from third parties (the "Information") has not been verified by CBRE, and CBRE does not represent, warrant or guarantee the accuracy, correctness and completeness of the Information. CBRE does not accept or assume any responsibility or liability, direct or consequential, for the Information or the recipient's reliance upon the Information. The recipient of the Information should take such steps as the recipient may deem necessary to verify the Information prior to placing any reliance upon the Information. The Information may change and any property described in the Information may be withdrawn from the market at any time without notice or obligation to the recipient from CBRE. CBRE and the CBRE logo are the service marks of CBRE Limited and/or its affiliated or related companies in other countries. All other marks displayed on this document are the property of their respective owners. All Rights Reserved.

www.nitcalgary.com

